

Versione vano in struttura metallica

Assenza porte in cabina (fotocellula a barriera), manuali al piano

Testata minima 2500 mm. Corsa max 14000 mm Fossa Minima 120 mm.

Velocità max m/s 0,15 Alimentaz.rete 230 v. Monofase

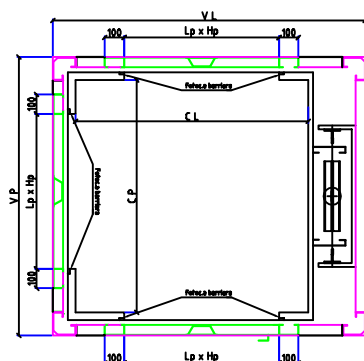
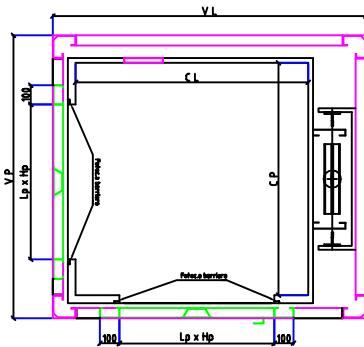
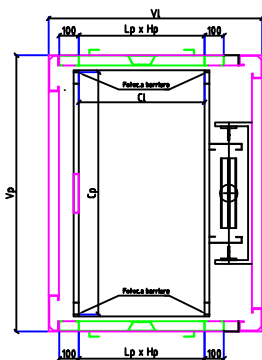
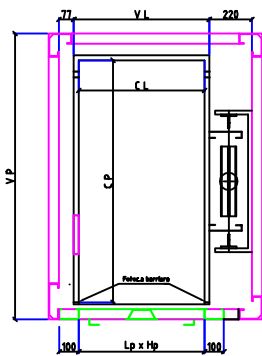
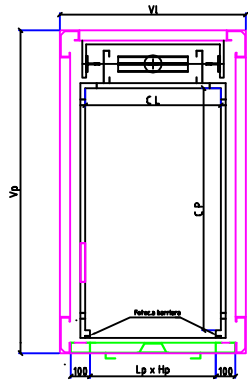

ALCUNE IPOTESI DI REALIZZAZIONE QUOTE IN MM.

Ingresso con guide lato corto	Portata Kg	Dimensioni Esterne Struttura VI x Vp	Dimensione Interna Cabina CL x Cp	Luce Passaggio Lp x Hp
	250	960 x 1666	700 x 1250	650 x 2000
	250	1060 x 1636	750 x 1250	750 x 2000
	250	1110 x 1636	800 x 1250	800 x 2000

Ingresso con guide lato lungo	Portata Kg	Dimensioni Esterne Struttura VI x Vp	Dimensione Interna Cabina CL x Cp	Luce Passaggio Lp x Hp
	250	1100 x 1476	650 x 1250	650 x 2000
	250	1200 x 1476	750 x 1250	750 x 2000
	250	1278 x 1500	850 x 1250	800 x 2000
	315	1326 x 1656	900 x 1400	800 x 2000

Ingressi frontali con guide lato lungo	Portata Kg	Dimensioni Esterne Struttura VI x Vp	Dimensione Interna Cabina CL x Cp	Luce Passaggio Lp x Hp
	250	1103 x 1426	650 x 1250	650 x 2000
	250	1203 x 1426	750 x 1250	750 x 2000
	250	1253 x 1426	800 x 1250	800 x 2000
	315	1330 x 1636	900 x 1400	800 x 2000

Ingressi laterali	Portata Kg	Dimensioni Esterne Struttura VI x Vp	Dimensione Interna Cabina CL x Cp	Luce Passaggio Lp x Hp
	385	1616 x 1510	1200 x 1250	800 x 2000
				800 x 2000

Tre Ingressi	PORTATA KG	MISURE ESTERNE VANO VL x VP	MISURE INTERNE CABINA CL x CP	LUCE PASSAGGIO LP x HP
	385	1616 x 1486	1200 x 1250	900 x 2000

PARTICOLARE ARMADIO

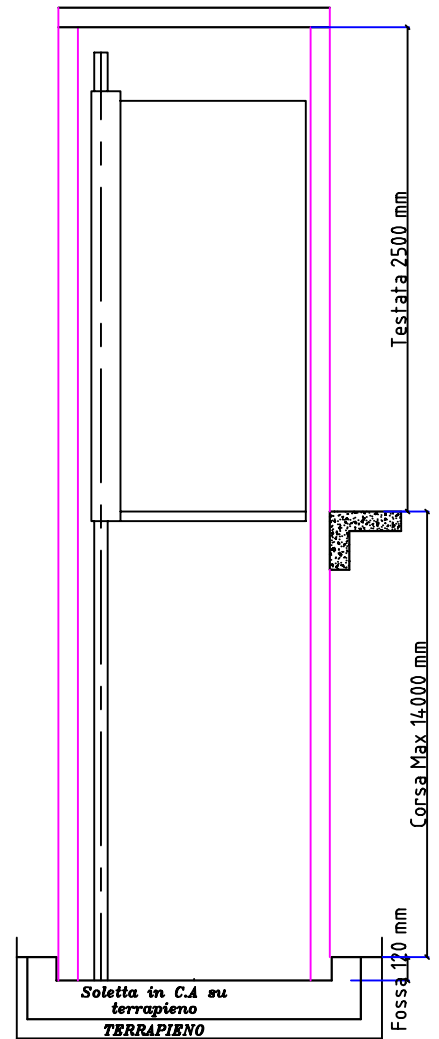
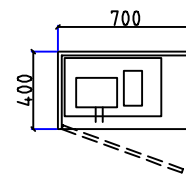
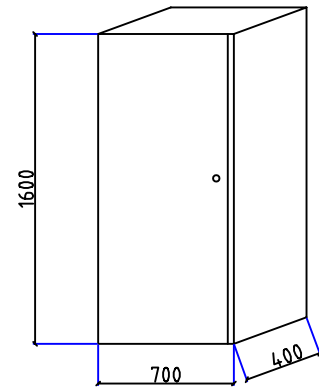

PER DIMENSIONI RIVERSE INVIARE RICHIESTA