

Versione vano in struttura metallica

Porte a soffietto in cabina e manuali al piano

Testata minima 2600 mm Corsa max 14000 mm Fossa minima 120 mm

Velocità max m/s 0,15 Alimentaz.rete 230 v monofase

PARTICOLARE ARMADIO

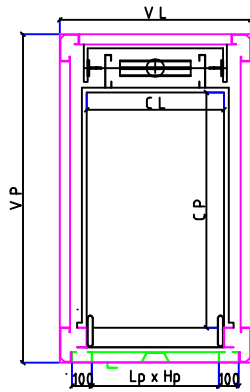

ALCUNE IPOTESI DI REALIZZAZIONE

Ingresso con guide lato corto	Portata Kg.	Dimensione Esterna Netta Vano VL x Vp	Dimensione Interna Cabina Cl x Cp	Luce Passaggio Lp x Hp
	250	976 x 1676	700 x 1200	650 x 2000
	250	1076 x 1676	800 x 1200	750 x 2000
	265	1126 x 1676	850 x 1200	800 x 2000

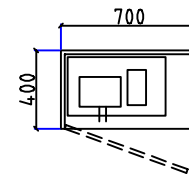
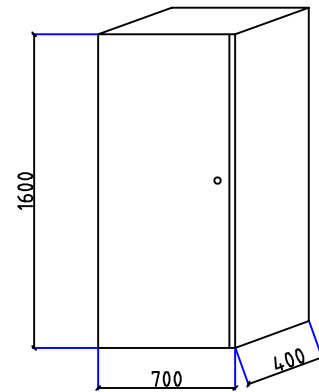

Ingresso con guide lato lungo	Portata Kg.	Dimensione Esterna Netta Vano VL x Vp	Dimensione Interna Cabina Cl x Cp	Luce Passaggio Lp x Hp
	250	1150 x 1510	700 x 1200	650 x 2000
	250	1250 x 1531	800 x 1200	750 x 2000
	265	1300 x 1531	850 x 1200	800 x 2000
	315	1335 x 1556	900 x 1400	800 x 2000

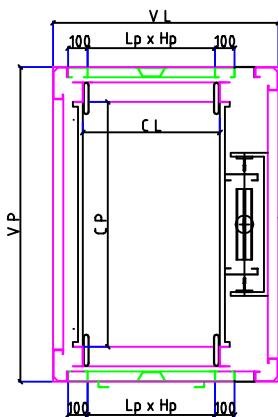
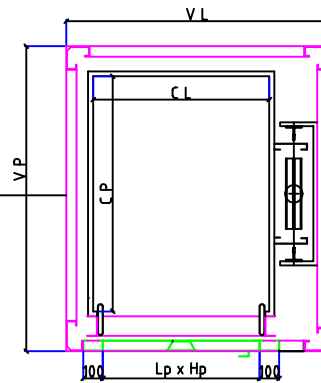

Ingressi frontali con guide lato lungo	Portata Kg.	Dimensione Esterna Netta Vano VL x Vp	Dimensione Interna Cabina Cl x Cp	Luce Passaggio Lp x Hp
	250	1150 x 1606	700 x 1250	650 x 2000
	250	1250 x 1606	800 x 1250	750 x 2000
	265	1300 x 1606	850 x 1250	800 x 2000
	315	1325 x 1806	900 x 1400	800 x 2000

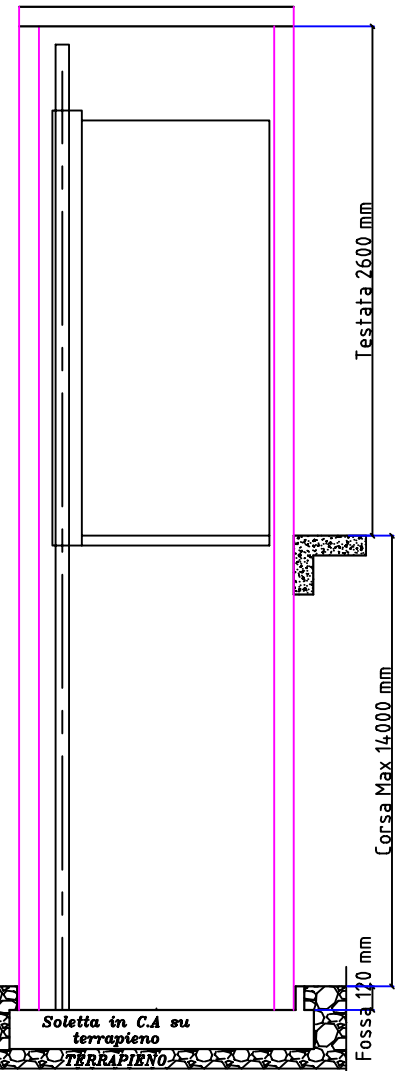

Ingressi laterali	Portata Kg.	Dimensione Esterna Netta Vano VL x Vp	Dimensione Interna Cabina Cl x Cp	Luce Passaggio Lp x Hp
	385	1700 x 1606	1200 x 1250	800 x 2000
				900 x 2000

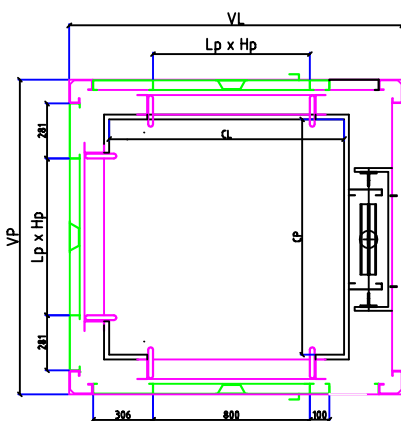
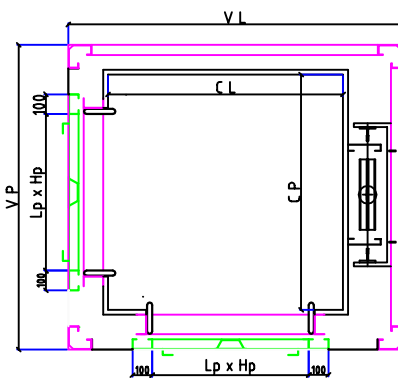

Tre Ingressi	Portata Kg.	Dimensione Esterna Netta Vano VL x Vp	Dimensione Interna Cabina Cl x Cp	Luce Passaggio Lp x Hp
	360	1700 x 1606	1200 x 1250	900 x 2000

PER DIMENSIONI RIVERSE INVIARE RICHIESTA